

2D RADIUS STANDARD BENDS

The following bends are available in descaled and polished O/D finish from T316L or T304L stainless steel material.

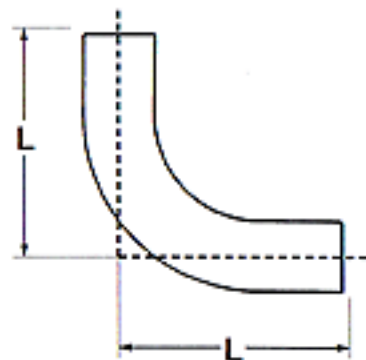

90° Bend

Tube Size	Ø	3/4" x 16g	1 1/2" x 16g	2" x 16g	2 1/2" x 16g	3" x 16g
Bend Radius	mm	38	76	101	127	152
L	mm	60	105	130	160	200

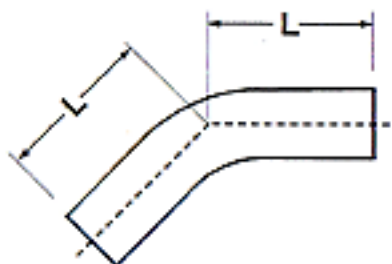

45° Bend

Tube Size	Ø	3/4" x 16g	1 1/2" x 16g	2" x 16g	2 1/2" x 16g	3" x 16g
Bend Radius	mm	38	76	101	127	152
L	mm	45	70	85	105	115

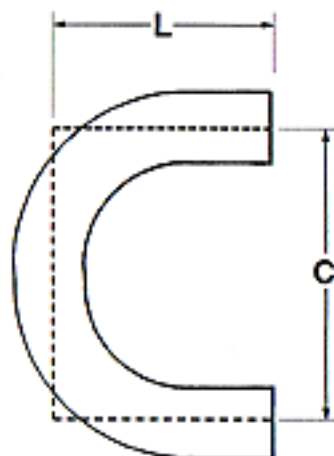

180° Bend

Tube Size	Ø	3/4" x 16g	1 1/2" x 16g	2" x 16g	2 1/2" x 16g	3" x 16g
Bend Radius	mm	38	76	101	127	152
L	mm	60	105	130	160	200
C	mm	80	155	206	260	310